

**Beacon**<sup>TM</sup> Brookings County, SD

### Summary

Parcel ID 043051104908300  
 Property Address 3421 30TH ST  
 Sec/Twp/Rng 8/110/49  
 Brief Tax Description TELKAMP ADDN LOT 1 IN SW 1/4 SEC 8-110-49 4.5 AC  
 (Note: Not to be used on legal documents)  
 Comments  
 Class NAC  
 Tax District 0401  
 Gross Acres 0.00  
 \$/Acre N/A



### Owners

Deed Holder  
 TELKAMP, BRUCE

801 LABARGE CT  
 PIERRE SD 57501

### Land

Gross Acres 4.50  
 Lot Size N/A

### Building

Residential Dwelling  
 Occupancy Single family  
 Style 21 Older 1 story  
 Year Built 1957  
 # of Stories 1.0  
 Above-Grade Living Area 1364 SF  
 Foundation Full Bsmt  
 Basement Area 1364 SF  
 Basement Finished  
 Recroom Finished N/A  
 Total Number Rooms 6 (Does not include bathrooms)  
 Number Bedrooms 3  
 Number Full Bathrooms 2  
 Number Half Bathrooms 0  
 Heating & Cooling Hot water  
 Fireplace None  
 Deck 1025 SF  
 Garage Detached: 748 SF;  
 Other Features Residential Detached Garage

### Sales

| Date       | Sequence | Seller                       | Buyer          | Book | Page | Type | Building Value | Land Value  | Transfer Fee | Sale Amount  |
|------------|----------|------------------------------|----------------|------|------|------|----------------|-------------|--------------|--------------|
| 04/18/2019 | 20190378 | TELKAMP, EDWARD LIVING TRUST | TELKAMP, BRUCE | D153 | 360  | T    | \$120,500.00   | \$49,000.00 | \$180.00     | \$180,000.00 |

### Valuation

|               | 2021      | 2020      | 2019      |
|---------------|-----------|-----------|-----------|
| + NAC1        | \$139,200 | \$120,500 | \$120,500 |
| + NAC         | \$49,000  | \$49,000  | \$49,000  |
| = Total Value | \$188,200 | \$169,500 | \$169,500 |

Disclaimer: All values reflect full and true values before any adjustments or exemptions are applied.

### Taxation

| 2020          | 1st Half       | 2nd Half         | Full Year |
|---------------|----------------|------------------|-----------|
| Due Date      | April 30, 2021 | October 31, 2021 |           |
| Tax Billed    | 1,431.44       | 1,431.44         | 2,862.88  |
| Specials Etc. | 0.00           | 0.00             | 0.00      |

|                |            |          |          |
|----------------|------------|----------|----------|
| Amount Paid    | 1,431.44   | 0.00     | 1,431.44 |
| Amount Due     | 0.00       | 1,431.44 | 1,431.44 |
| Payment Status | Paid       |          |          |
| Date Paid      | 04/26/2021 |          |          |

| 2019           | 1st Half       | 2nd Half         | Full Year |
|----------------|----------------|------------------|-----------|
| Due Date       | April 30, 2020 | October 31, 2020 |           |
| Tax Billed     | 1,414.23       | 1,414.23         | 2,828.46  |
| Specials Etc.  | 0.00           | 0.00             | 0.00      |
| Amount Paid    | 1,414.23       | 1,414.23         | 2,828.46  |
| Amount Due     | 0.00           | 0.00             | 0.00      |
| Payment Status | Paid           |                  |           |
| Date Paid      | 01/15/2020     | 10/26/2020       |           |

Photos



Sketches

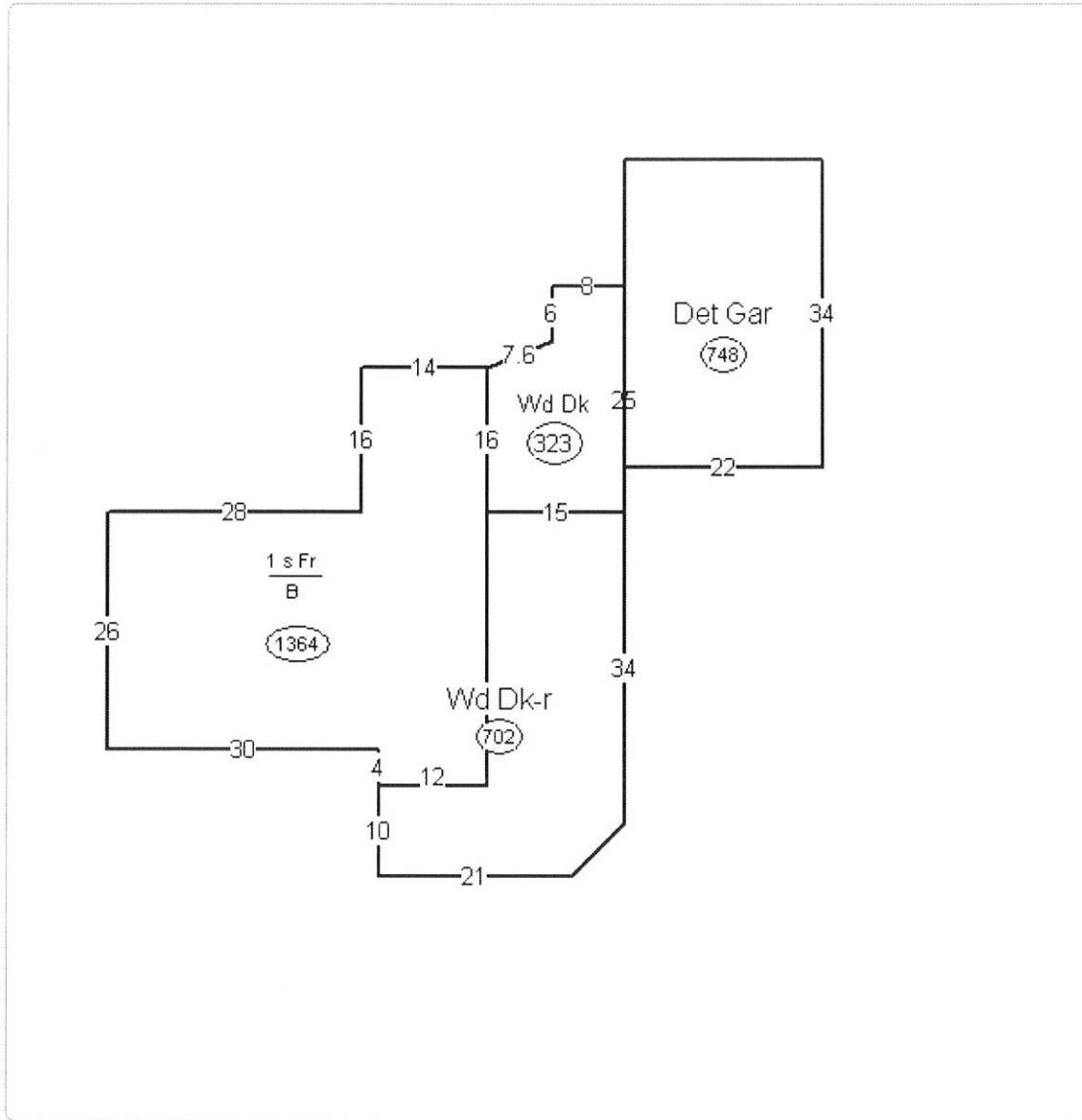

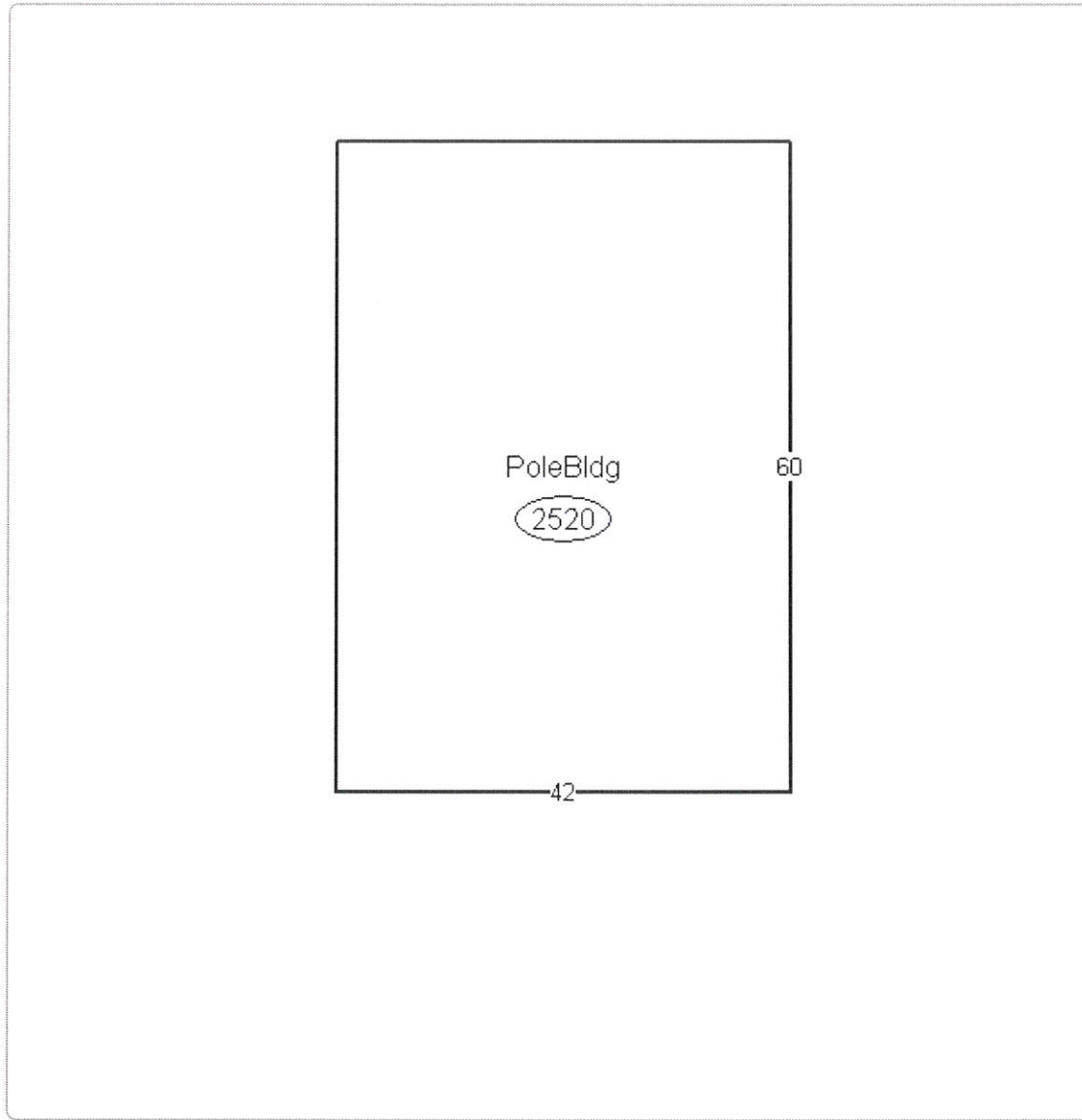

No data available for the following modules: Comments.

Brookings County digital cadastral data are a representation of recorded plats and surveys for use within the Geographic Information System for purposes of data access and analysis. These and other digital data do not replace or modify land surveys, deeds, and/or other legal instruments defining land ownership or use.

[User Privacy Policy](#)  
[GDPR Privacy Notice](#)

[Last Data Upload: 7/7/2021, 7:07:07 AM](#)

Version 2.3.128

Developed by  
 Schneider  
GEOSPATIAL